

# LIVING STREET

enhance community, ecology, + mobility at Washington Terrace

Washington Terrace is a newly constructed affordable housing community in Raleigh, NC. The concept of the Living Street was inspired by three precedent models: Woonerfs, Superblocks, and Covid-era Slow Streets. Each of these models helped inspire the design of a slow, one-way traffic loop that curves through the site in between added vegetative areas and increased

pedestrian plazas. The community park was inspired by the community feedback and features a flexible lawn for events, a pavilion, and exploratory gardens and play features. The combination of the park design and the street reconfiguration will help to connect the community to the park and to one another, resulting in a safer, healthier, and happier community.

## RESPONSIBLE STORMWATER MANAGEMENT

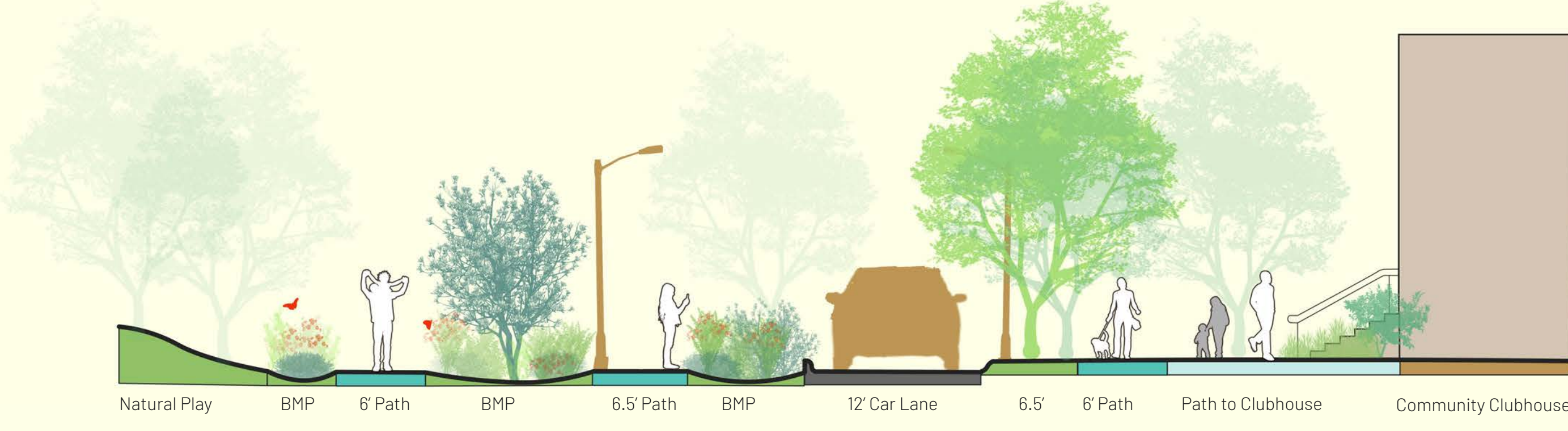

## SAFER STREETS, ENHANCED MOBILITY

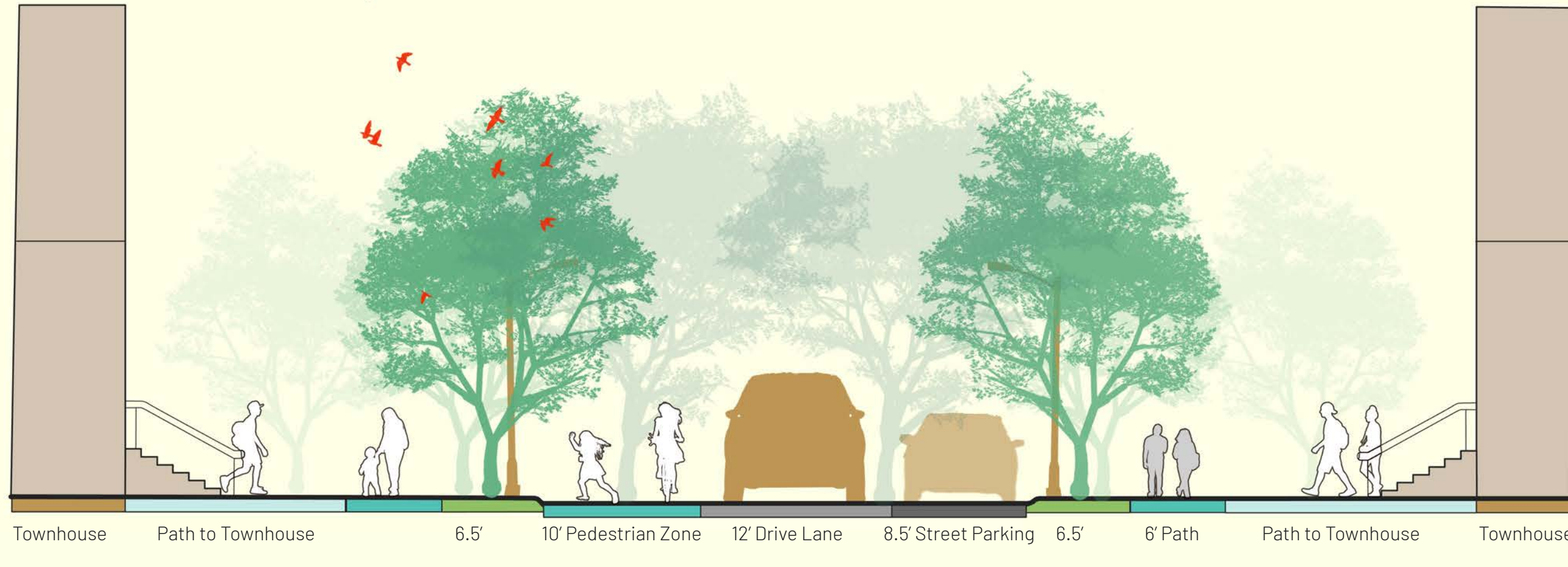

## EXISTING CONDITIONS

car dominated + limited pedestrian activity



The current streetscape conditions are a 30' wide street with planting strips and street trees on either side. A majority of the space in the street is empty or used for street parking. The cars essentially separate one side of the neighborhood from the other.

Along Booker Drive, where the proposed park will be constructed, there are no cross walks or cues to slow for pedestrians. As it currently exists, the road and cars separate the community from the community park space.

## SLOW STREET, ENHANCED COMMUNITY

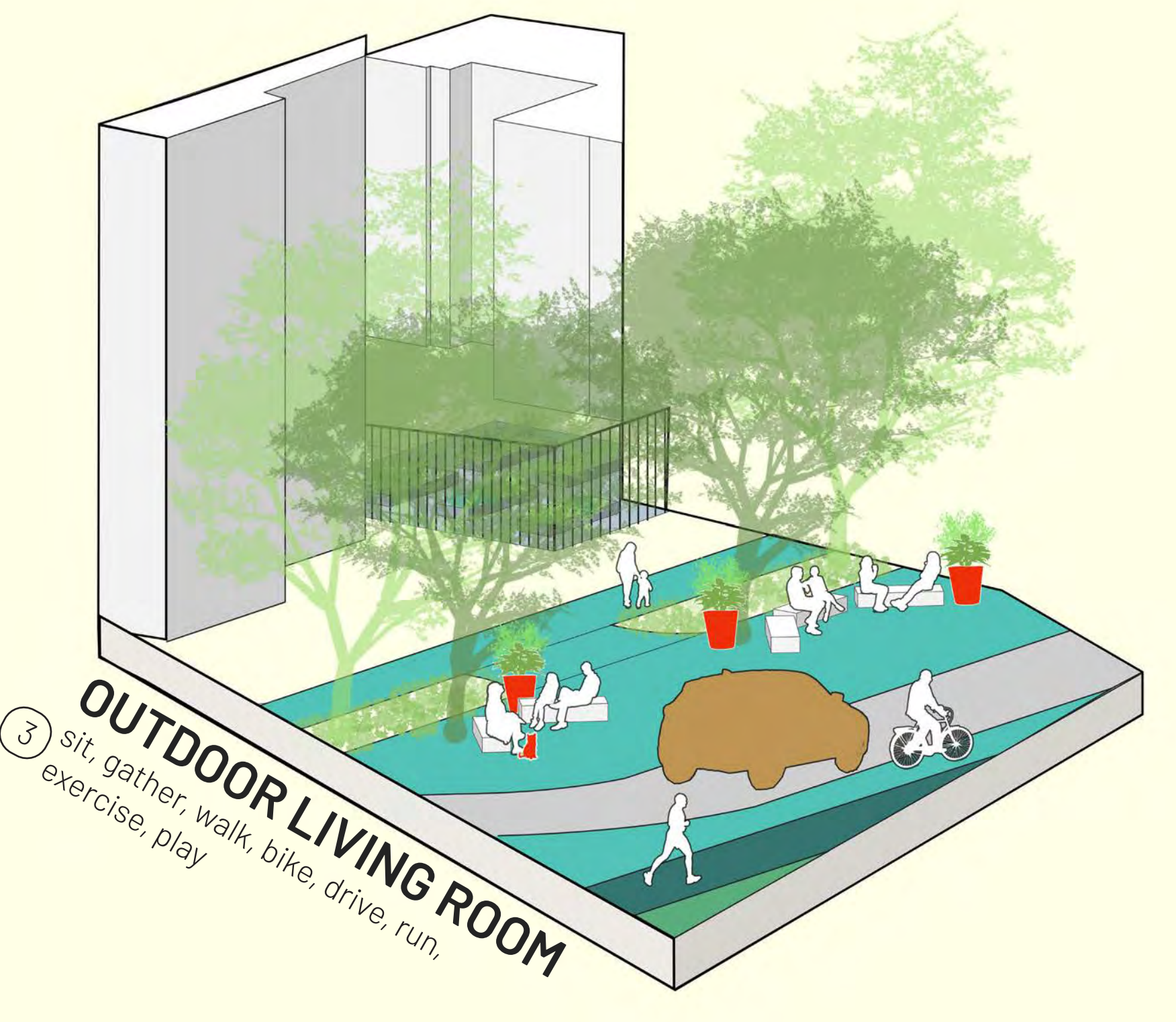
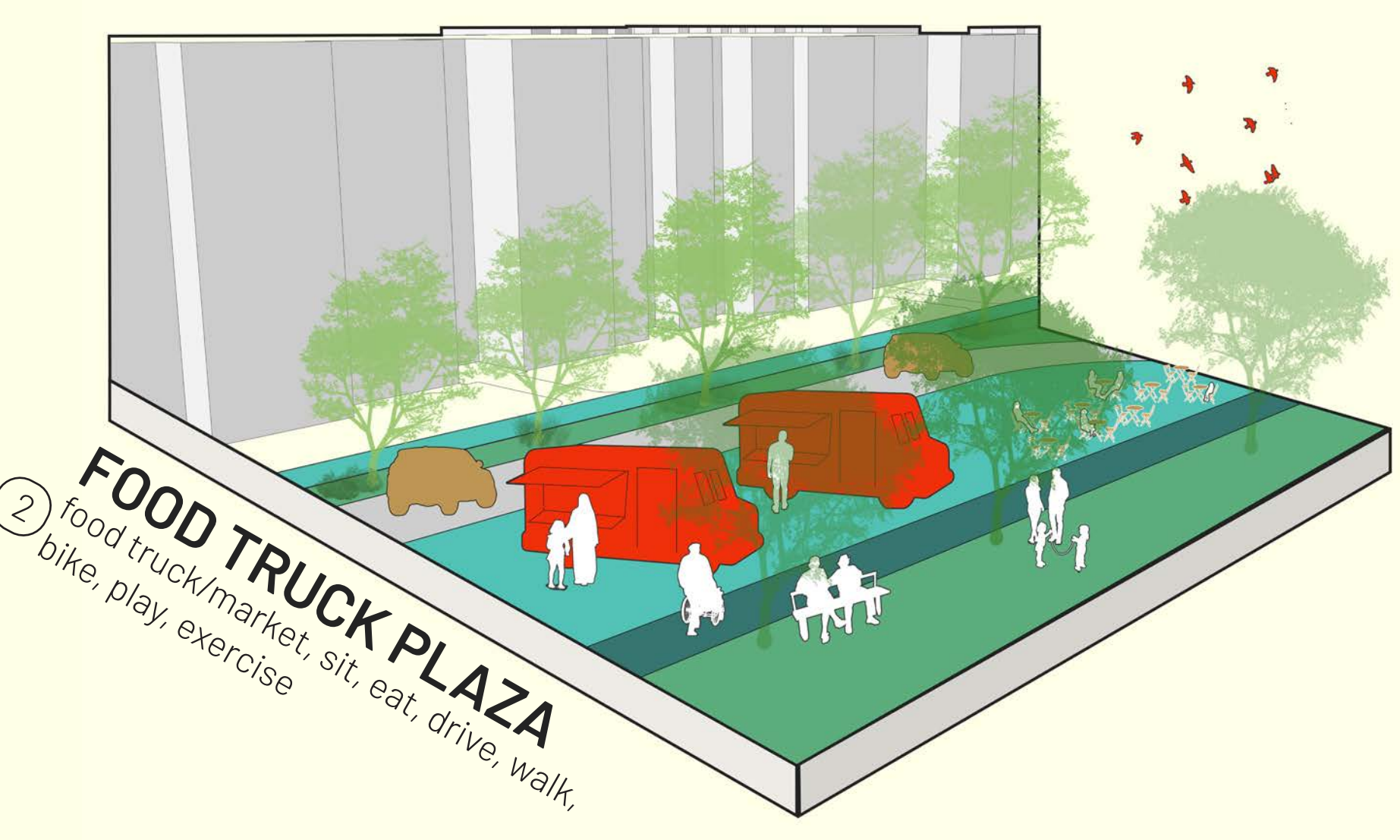
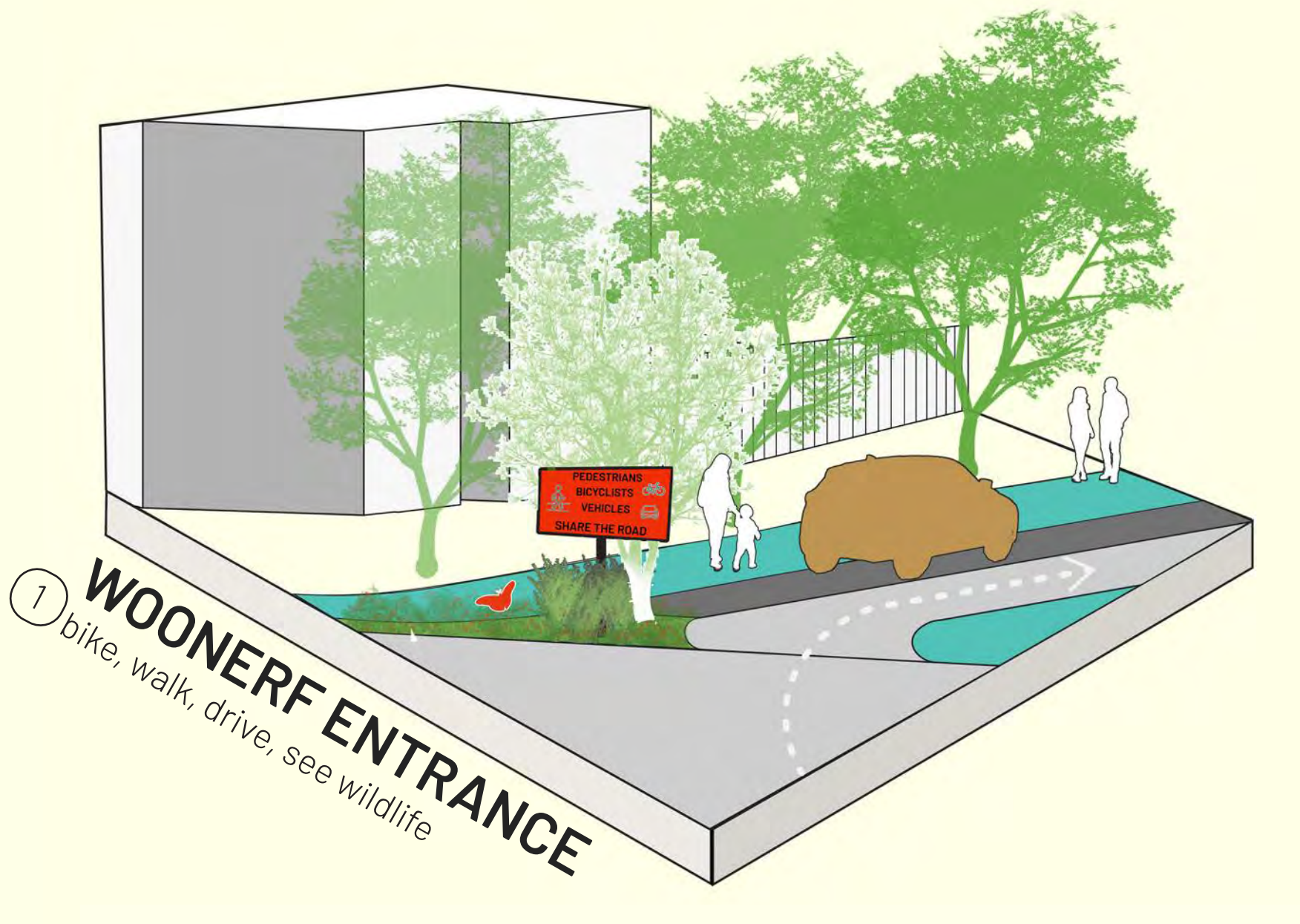
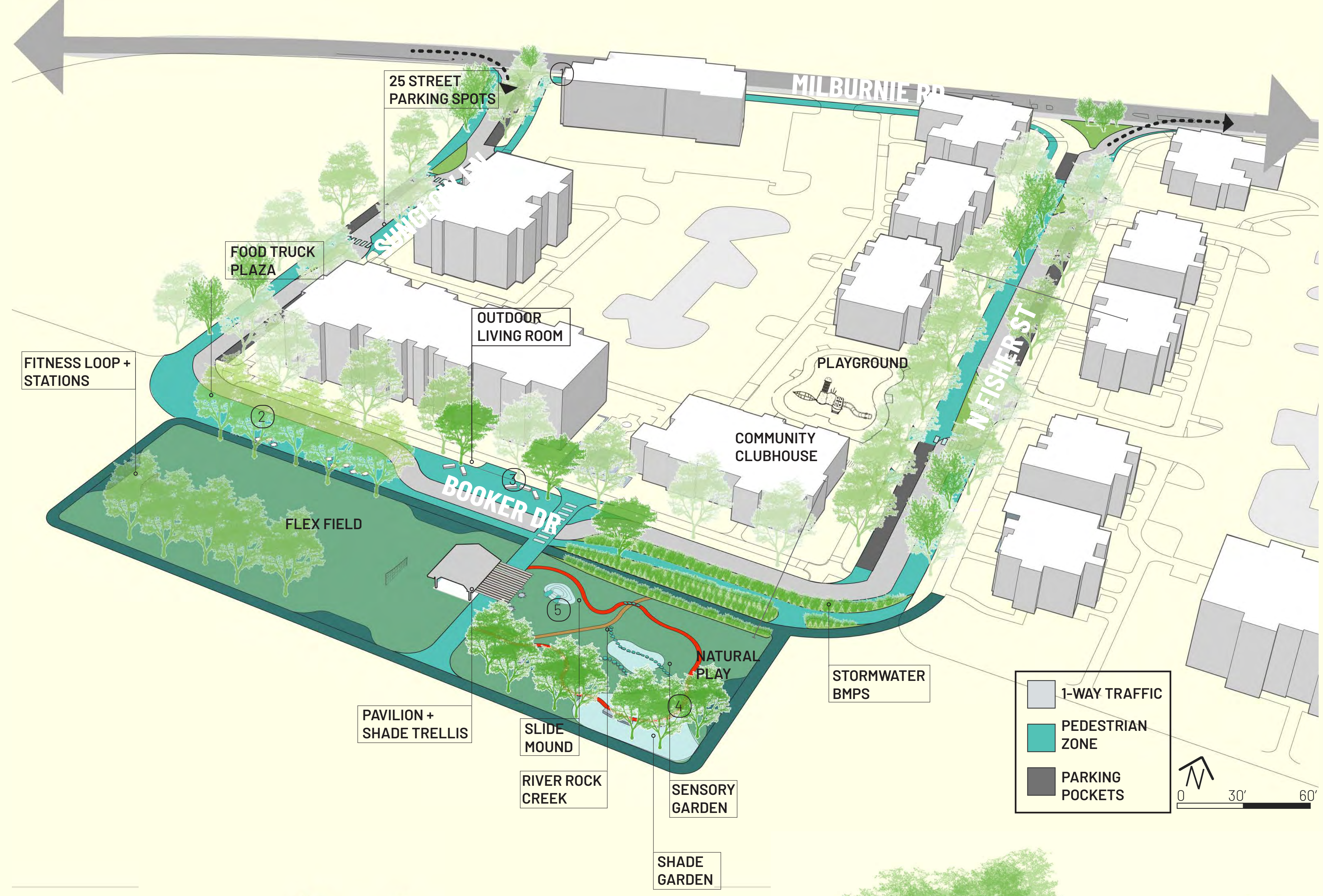

## FRAMEWORK + GOALS

**rethink the street**

- living room, rest, chat, connect
- activity: play, movement, safety
- feeling of place: lighting, community collaboration, art

**flexible community park**

- track: biking, exercise, walking
- moveable elements: play, seating
- lawn space: sports, events

**ECOLOGY**

- low maintenance
- creative play areas
- increased biodiversity
- ecosystem services
- stormwater management

**COMMUNITY**

- space for family gatherings
- grills, shelter, picnics
- open space for sports
- flex street market space
- intergenerational opportunities
- cars + pedestrians safe

**MOBILITY**

- slow, one-way vehicular traffic
- bike + skate paths
- walking + jogging paths
- accessibility
- enhanced circulation

\*Stakeholder Goals \*Designer Goals

## INTERGENERATIONAL USER PROFILES

**YOUNG CHILDREN**

- play spaces
- bike + scooter paths
- nature exploration

**TEENAGERS**

- hang out spots
- seating
- places to be seen
- bike + skate spots

**ADULTS**

- places to walk/exercise
- gathering spaces
- event amenities
- resting places

**FAMILIES**

- places to play
- gathering spaces
- event amenities
- safe paths + shade

**ELDERLY**

- resting places
- people watching places
- event amenities
- exercise + walking path



## TACTICAL TO STRUCTURAL URBANISM

a model for implementing changes to the urban setting



## ENHANCED ECOLOGY

planting suggestions for increased biodiversity + ecosystem services

<p><b>street planters</b></p> <ul style="list-style-type: none"> <li>River Birch</li> <li>Red Oak</li> <li>Little Bluestem</li> <li>Creeping Juniper</li> </ul>	<p><b>rain gardens</b></p> <ul style="list-style-type: none"> <li>Sea Oats</li> <li>Spikerush</li> <li>Inkberry</li> <li>Goldenrod</li> <li>Switchgrass</li> <li>Joe Pye Weed</li> <li>New England Aster</li> </ul>	<p><b>shade plants</b></p> <ul style="list-style-type: none"> <li>Fern</li> <li>Columbine</li> <li>Bugleweed</li> <li>Hosta</li> <li>Aucuba</li> </ul>	<p><b>sensory gardens</b></p> <ul style="list-style-type: none"> <li>Lamb's Ear</li> <li>Lavender</li> <li>Salvia</li> <li>Gray's Sedge</li> <li>Black-Eyed Susan</li> <li>Coneflower</li> </ul>	<p><b>trees</b></p> <ul style="list-style-type: none"> <li>Red Maple</li> <li>Southern Magnolia</li> <li>Red Bud</li> <li>Chaste Tree</li> <li>Black Gum</li> <li>Eastern Red Cedar</li> <li>Serviceberry</li> </ul>
---	---	--	--	--

# LIVING STREET

enhance community, ecology, + mobility at Washington Terrace

Madison Sweitzer - LAR 507 - Spring 2022



live, work (out), play in the street



exploratory, sensory gardens